

# AVAILABLE INDUSTRIAL SITE

DOTHAN AIRPORT INDUSTRIAL PARK  
OLD 231 NORTH, DOTHAN, DALE, AL, 36303



## Description

Dothan piggyback service available. Designated as a General Purpose Foreign Trade Zone area under Zone Number 233. 8 inch main with 800 psi available at 6200 feet

## Comments

### Sale / Lease

**For Sale:** Yes  
**Sale Price:** \$ 20,000.00 per acre  
Sale Price \$20,000 per acre for non-run way land; \$50,000 per acre lease price for runway access. .

### Utilities

**Electric Provider:** Alabama Power Company  
**Electric Provider 2:**  
**Natural Gas Provider:** Southeast Alabama Gas  
**Natural Gas Size of Main:** 2"  
**Water Provider:** City of Dothan  
**Water Size of Main:** 12"  
**Telecommunications Provider:** CenturyLink  
**Fiber Available:**  
**DSL Available:**  
**Sewer Provider:** City of Dothan  
**Sewer Size of Main:** 8"

### Zoning

**Zoning:**

### Port

**Nearest Port:**  
**Dock Distance:**

### Property Details

**Latitude:** 31.327900  
**Longitude:** -85.464000  
**Total Acreage:** 300 Acre(s)  
**Available Acres:** 240 Acre(s)  
**Largest Tract Available:** 100 Acre(s)  
**Smallest Tract Available:** 2 Acre(s)  
**Expandable:**  
**Wetlands:**  
**Phase 1 Audit Done:** Yes

### Interstate/Highway

**Interstate:** I-10  
**To Interstate (miles):** 45.00 Mile(s)  
**Interstate #2:**  
**To Interstate #2 (miles):**  
**Highway:** 134  
**To Highway (miles):** On-Site  
**State Highway:**  
**To State Highway (miles):**

### Rail

**Carrier:** CSX Transportation  
**Rail 1 Track Status:**  
**Rail 2 Track Status:**

## Advantage Alabama

**6** Interstates converge in Alabama

**All** Communities within 2 hours of a commercial airport

**92** Public-use airports

**5** Class 1 railroads and multiple short line railroads

Deep water port on the Gulf of Mexico

One of the longest inland waterway systems

Right-To-Work state

**WIN** with Alabama

For more information, please contact:

Ozark-Dale County Economic Development Corporation  
Holle Smith  
(334) 443-2000  
hsmith@odedc.com

Economic Development Partnership of Alabama  
1320 1st Avenue South  
Birmingham, AL 35233  
Greg Blalock  
Project Director  
P 205.943.4700  
gblalock@edpa.org  
<https://www.edpa.org>

# AVAILABLE INDUSTRIAL SITE

DOTHAN AIRPORT INDUSTRIAL PARK  
OLD 231 NORTH, DOTHAN, DALE, AL, 36303

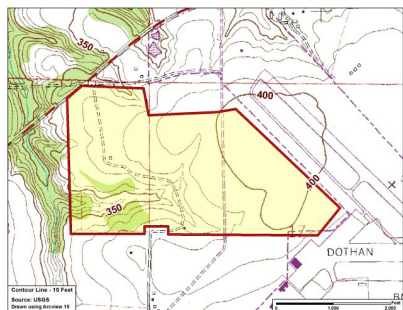

## Advantage Alabama

**6** Interstates converge in Alabama

**All** Communities within 2 hours of a commercial airport

**92** Public-use airports

**5** Class 1 railroads and multiple short line railroads

Deep water port on the Gulf of Mexico

One of the longest inland waterway systems

Right-To-Work state

**WIN** with Alabama

For more information, please contact:

Ozark-Dale County Economic Development Corporation  
Holle Smith  
(334) 443-2000  
hsmith@odedc.com

Economic Development Partnership of Alabama  
1320 1st Avenue South  
Birmingham, AL 35233  
Greg Blalock  
Project Director  
P 205.943.4700  
gblalock@edpa.org  
<https://www.edpa.org>